

5FT-CHARTWELL TRIPLE

ASSEMBLY INSTRUCTION GUIDE

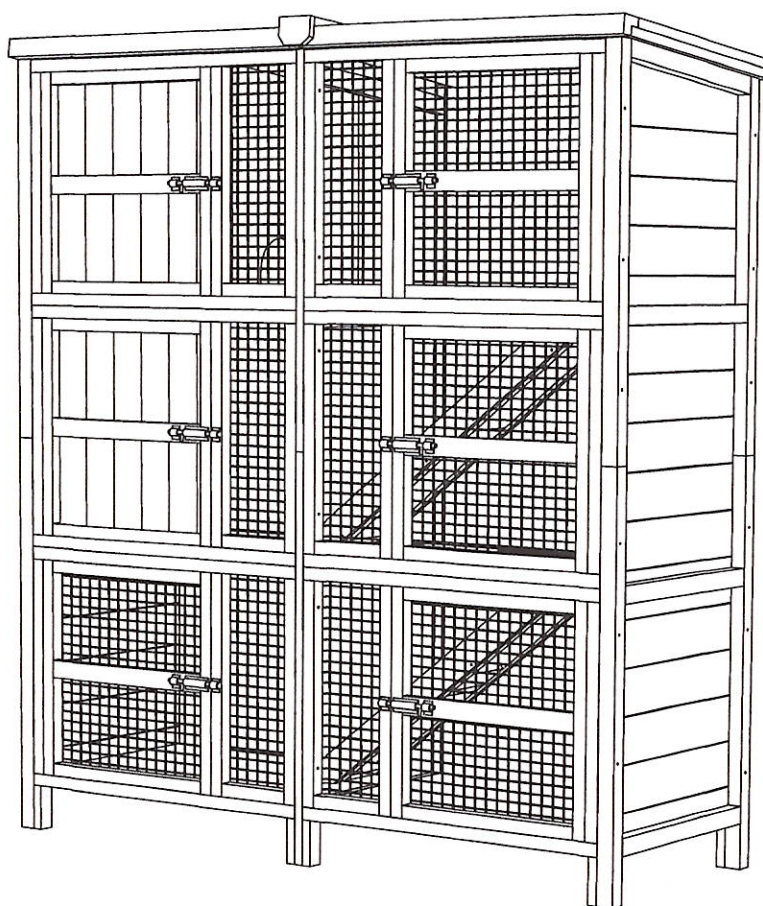

THC

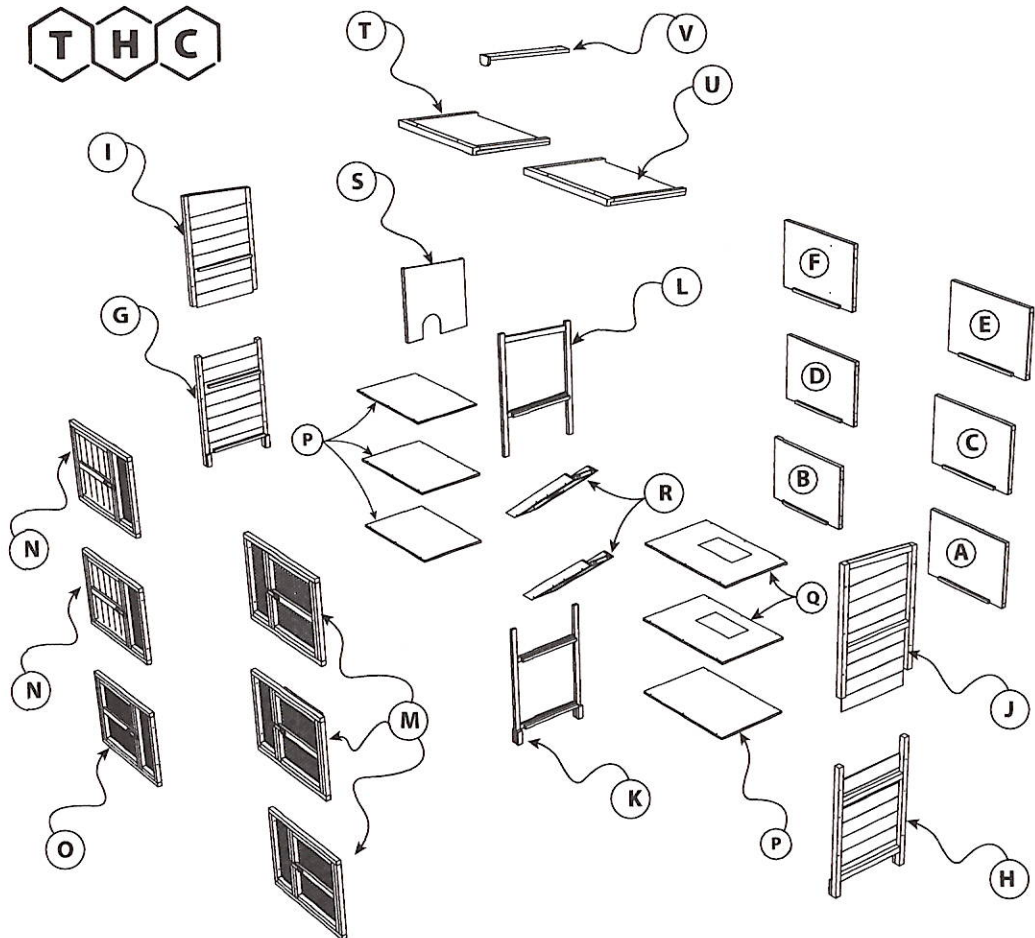

PART LIST

PART NUMBER	PART NAME	QTY	PART NUMBER	PART NAME	QTY
A	BOTTOM BACK-LEFT	1	L	PARTITION1-UPPER PART	1
B	BOTTOM BACK-RIGHT	1	M	DOOR-1	3
C	MID BACK-LEFT	1	N	DOOR-2	2
D	MID BACK-RIGHT	1	O	DOOR-3	1
E	UPPER BACK-LEFT	1	P	SHELF-1	4
F	UPPER BACK-RIGHT	1	Q	SHELF-2	2
G	RIGHT SIDE- LOWER PART	1	R	STAIR	2
H	RIGHT SIDE- LOWER PART	1	S	PARITION-2	1
I	LEFT SIDE-UPPER PART	1	T	TOP-LEFT	1
J	RIGHT SIDE- UPPER PART	1	U	TOP-RIGHT	1
K	PARTITION1-LOWER PART	1	V	TOP-SUPPORT	1

THC

IMPORTANT NOTES

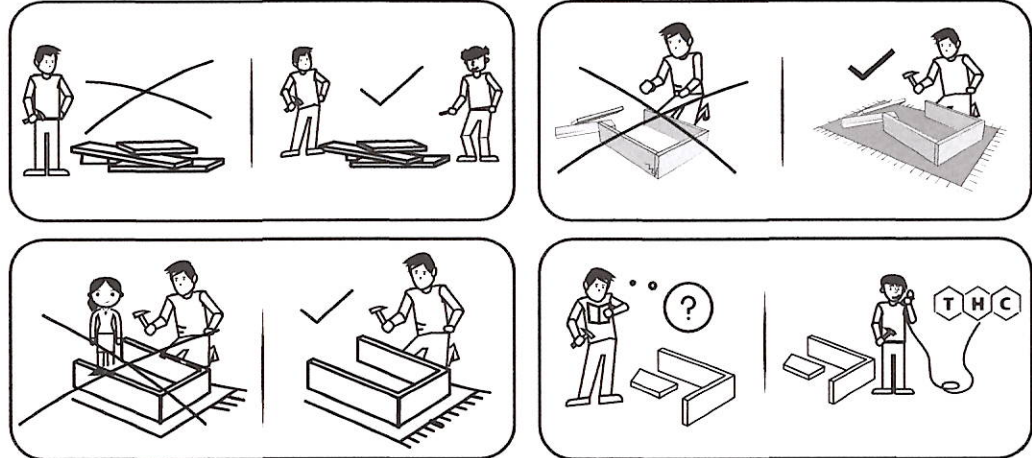

(A) Place all wooden parts on a clean and smooth surface such as a rug or carpet to avoid the parts from being scratched.

(B) Check to be sure that you have all parts and hardware.

(C) Keep all hardware parts out of reach of children

HARDWARE & TOOL DETAILS



HARDWARE LIST

NAME	SIZE/DMS	CODE	QTY
STAR SCREW	50 mm	1001	42 Nos
STAR SCREW	40 mm	1002	28 Nos
STAR SCREW	20 mm	1003	64 Nos
STAR SCREW DRIVER	NOT PROVIDED		

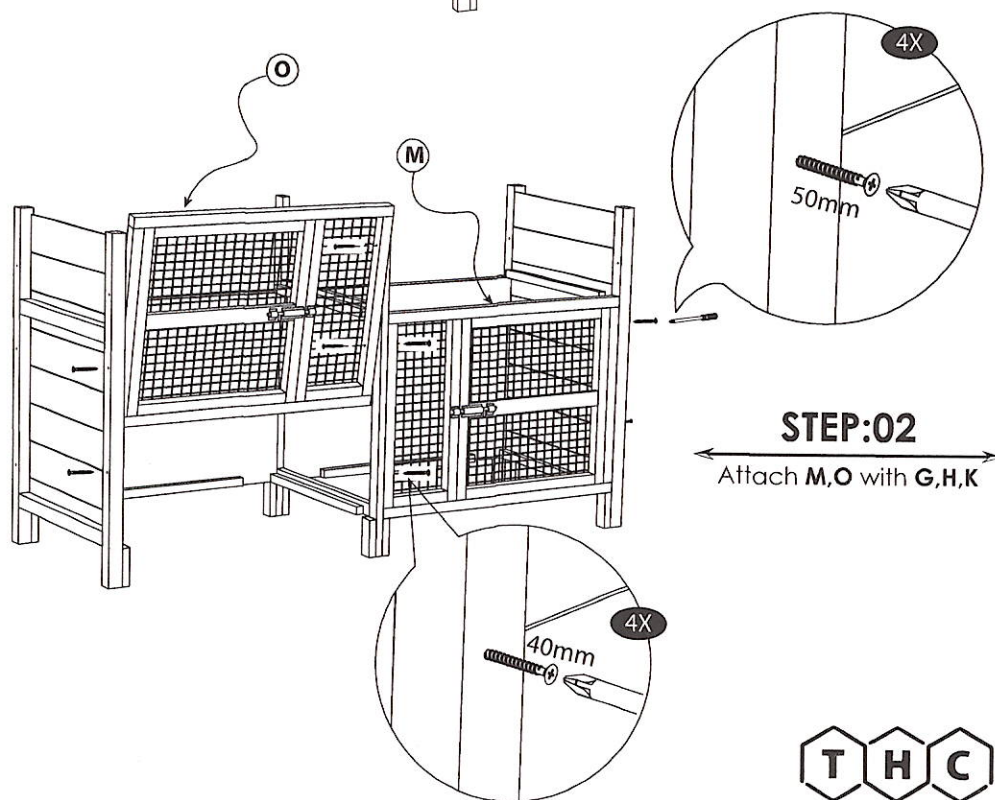
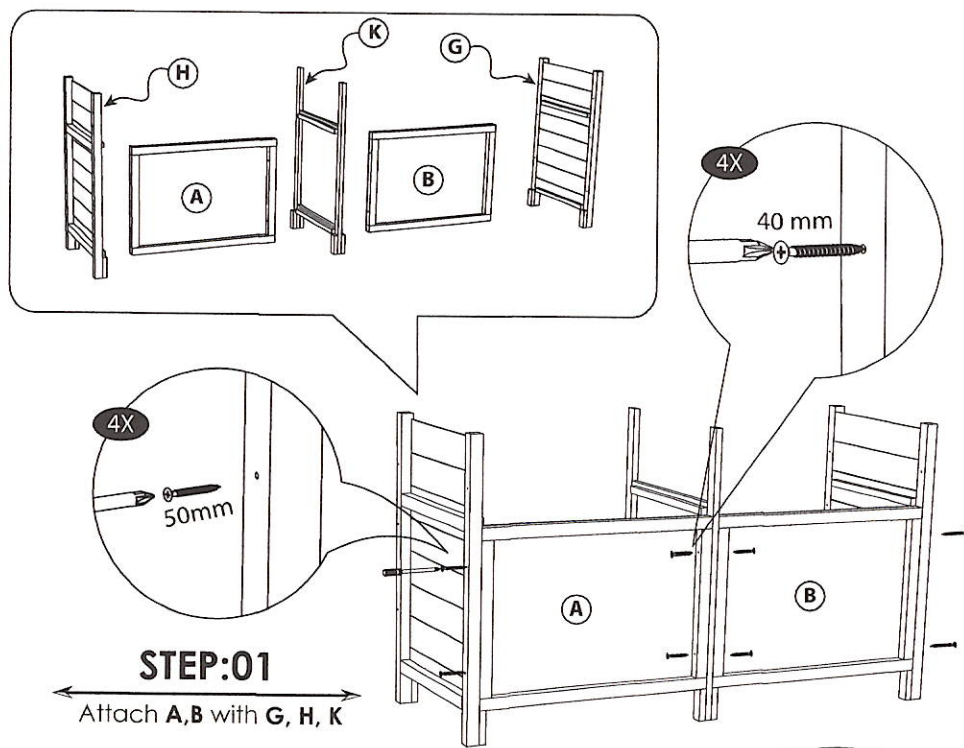

T H C

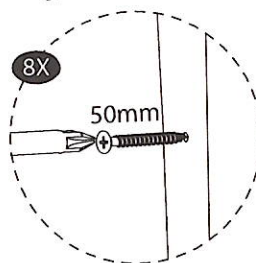
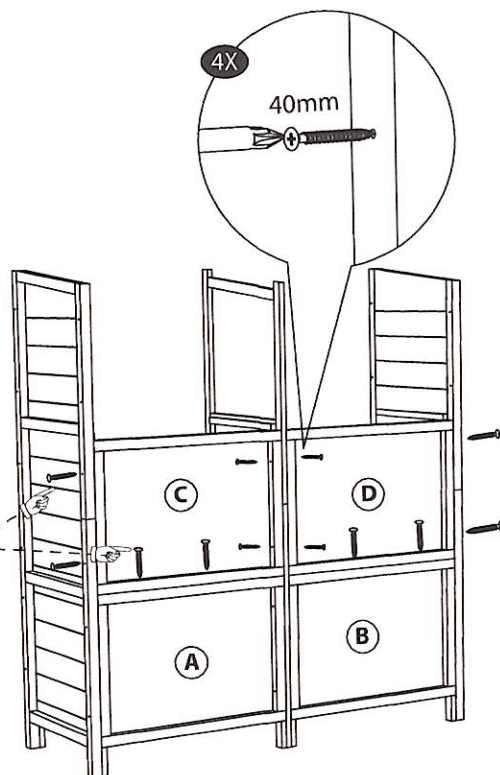
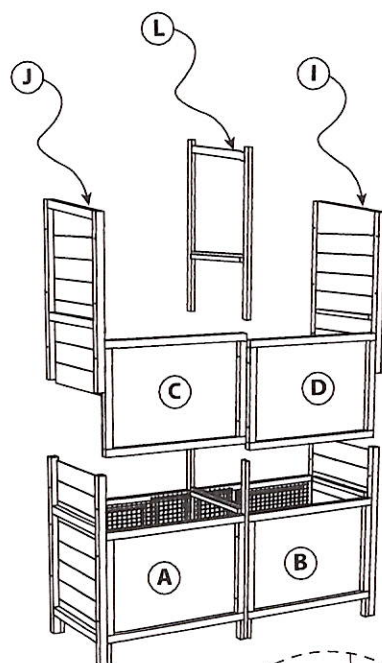
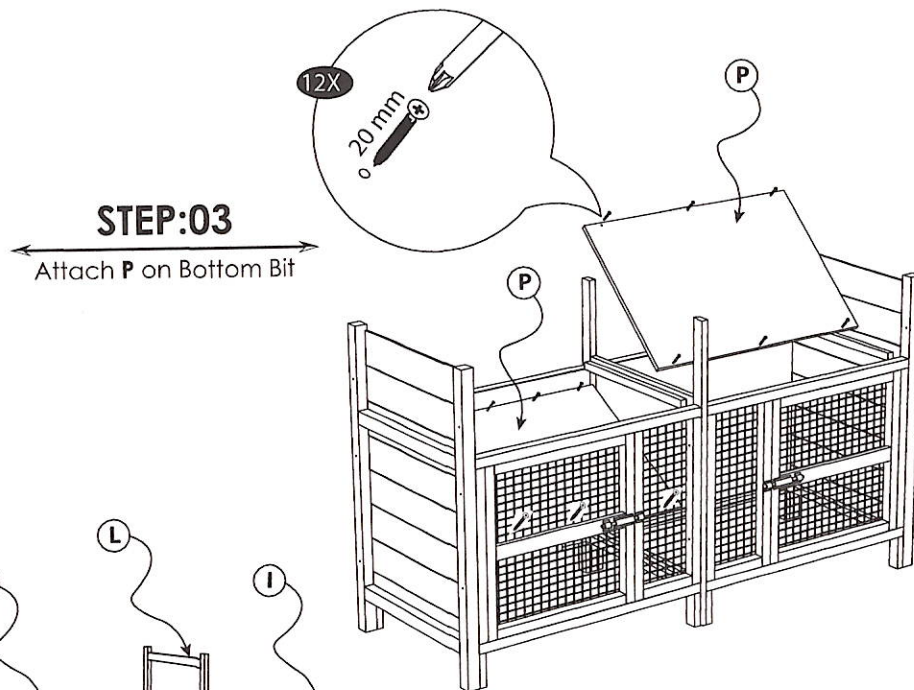

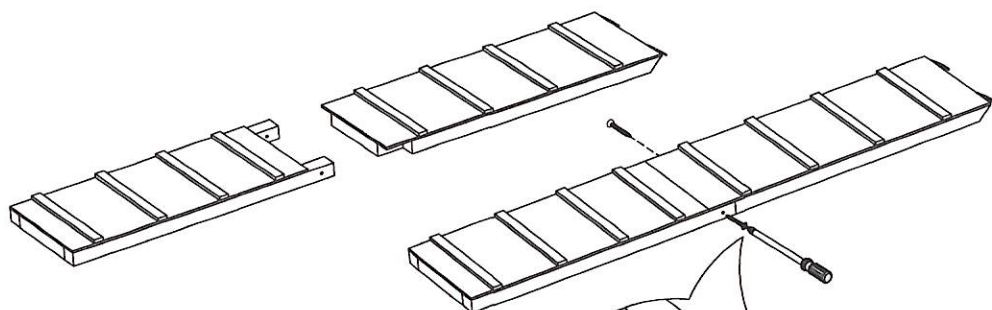

STEP:05

40 mm [2stari X 2pcs = 4pcs]

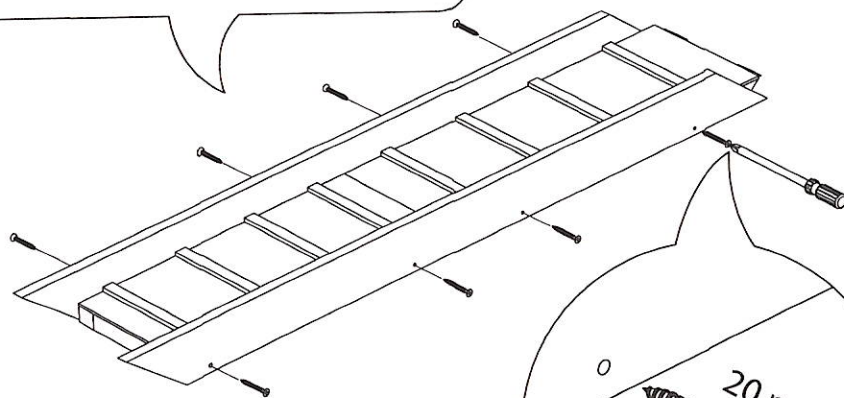
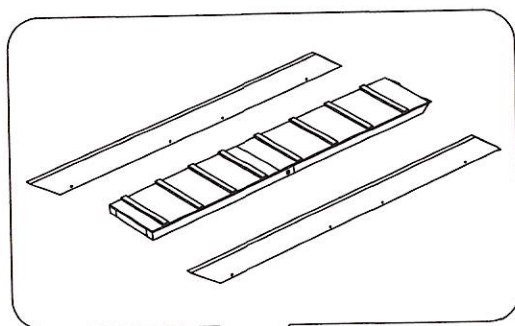
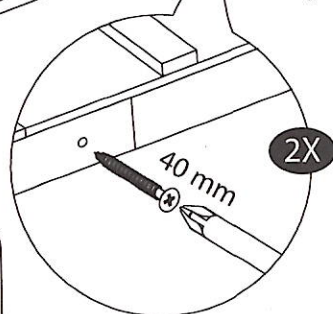

STEP:06

20 mm [2stari X 8pcs = 16pcs]

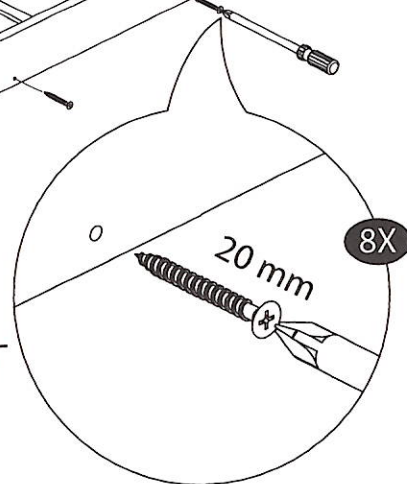

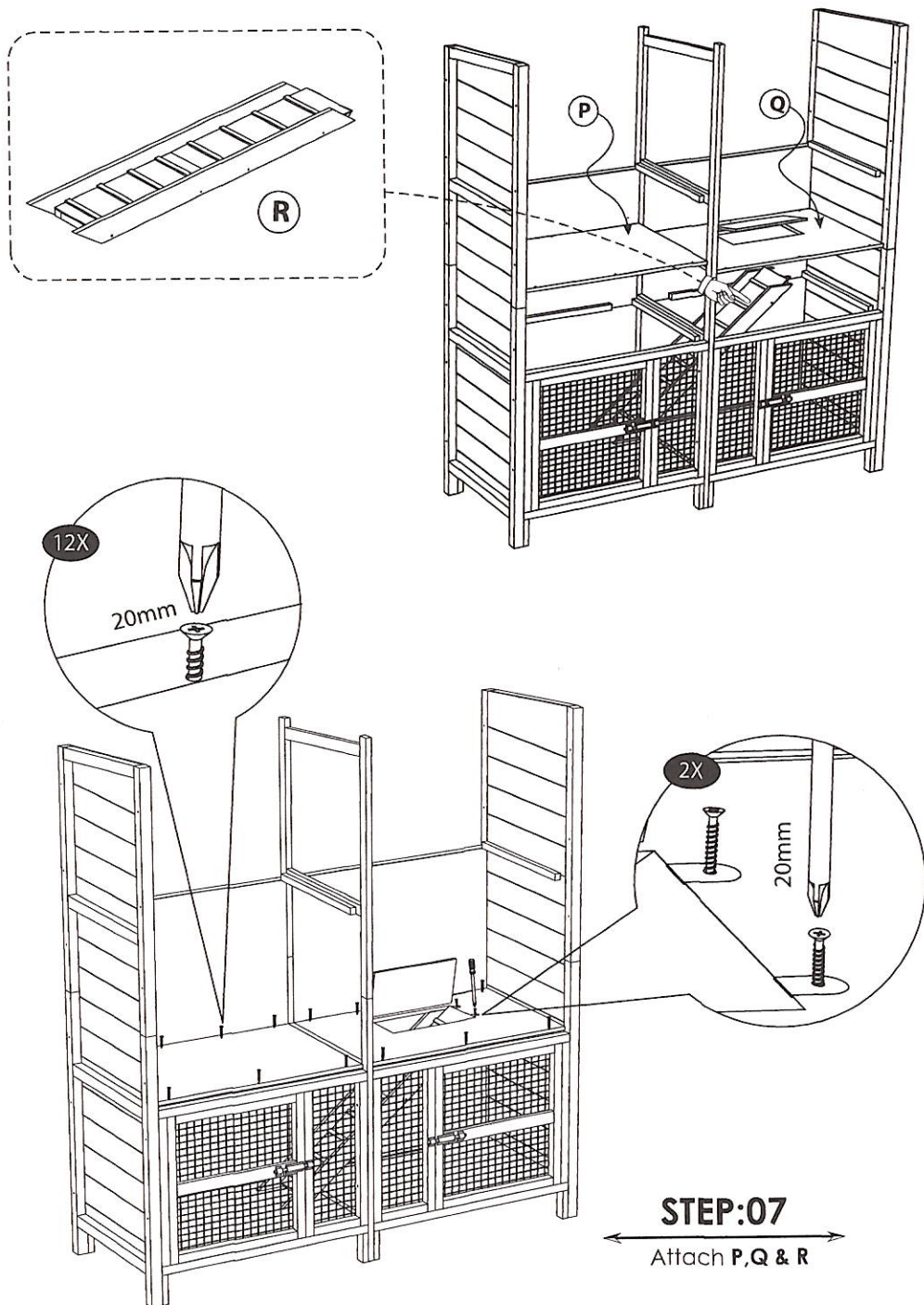

**ASSEMBLY
INSTRUCTIONS**

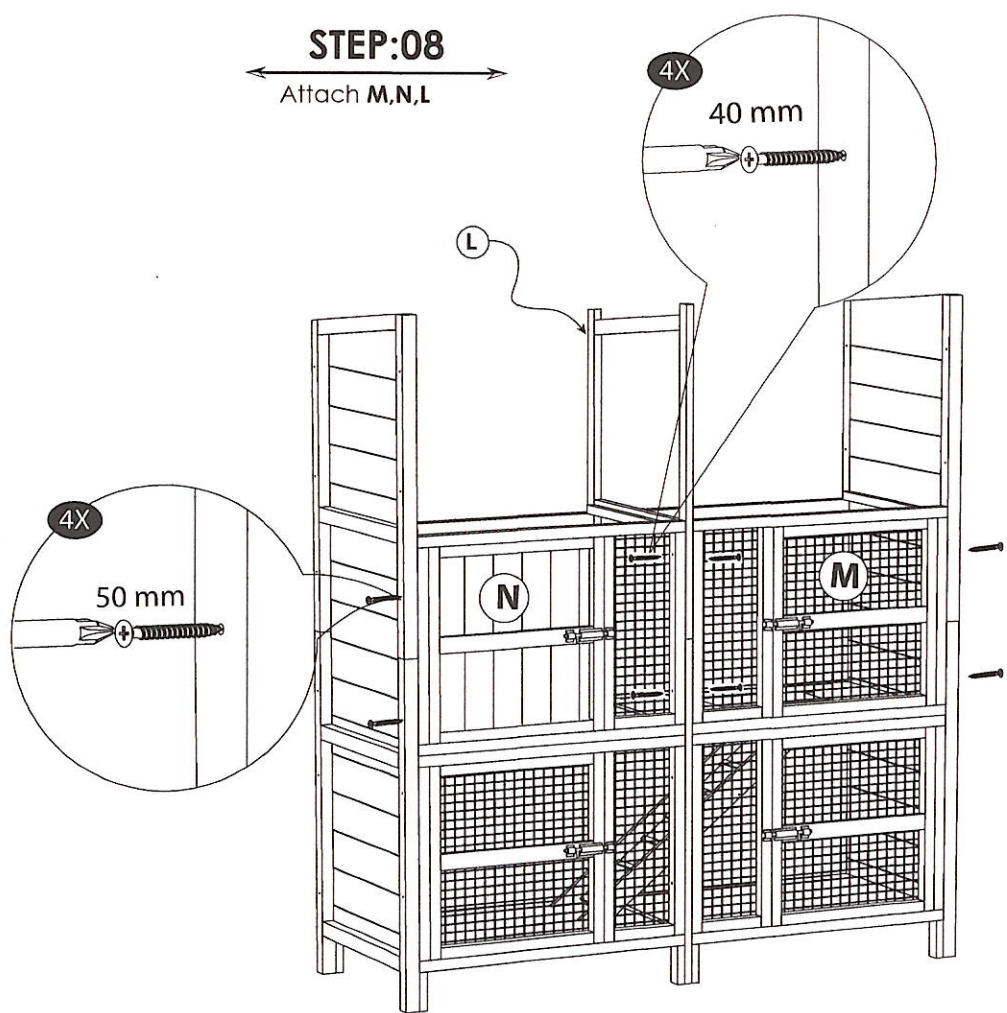

STEP:09

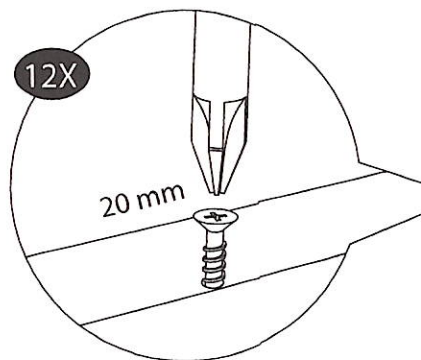
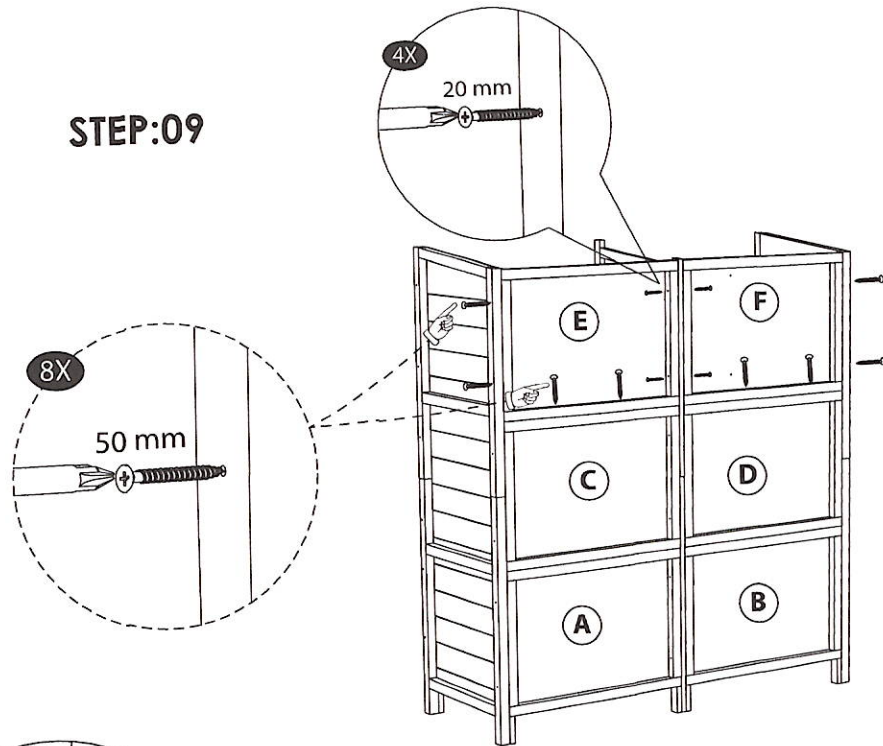

STEP:10

Attach P,Q With following Postion

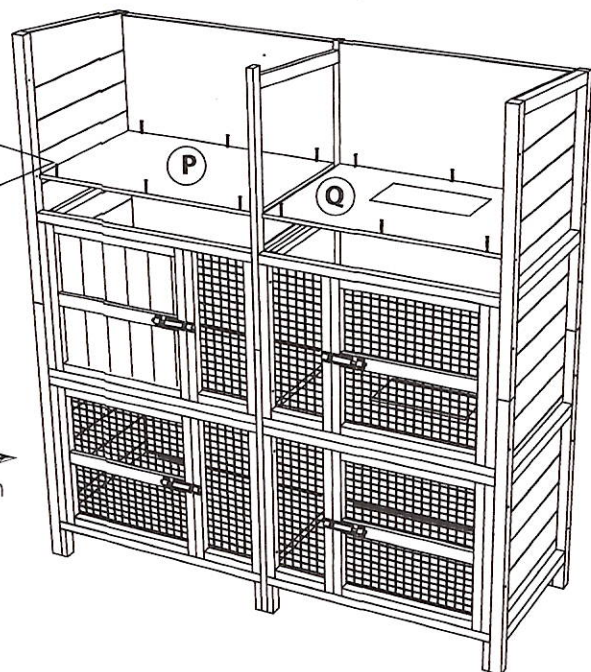

ASSEMBLY
INSTRUCTIONS

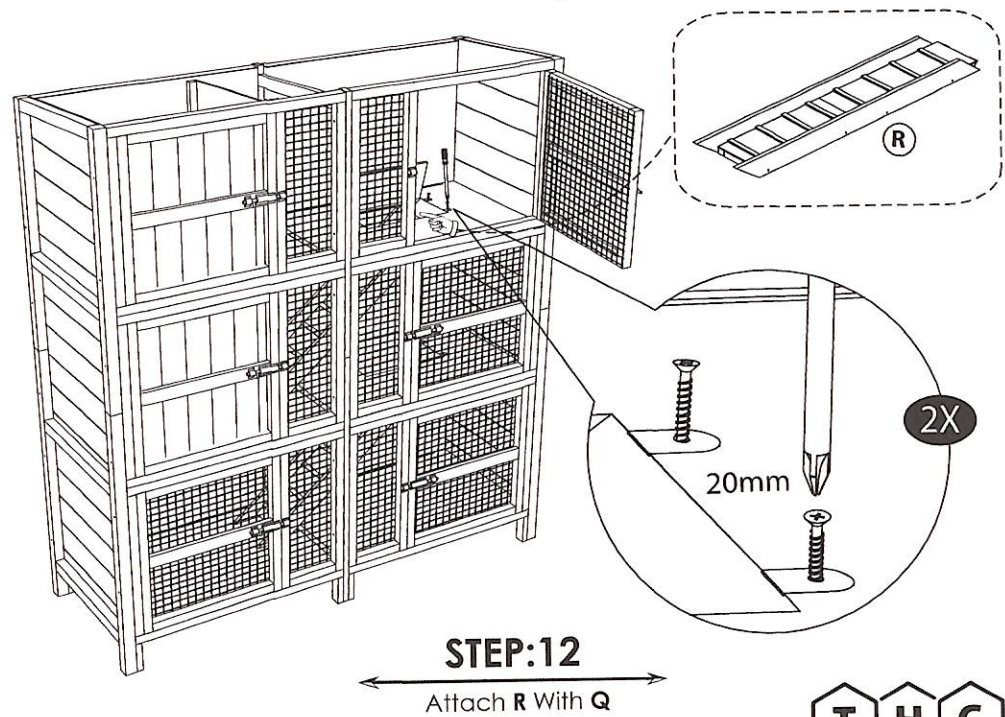
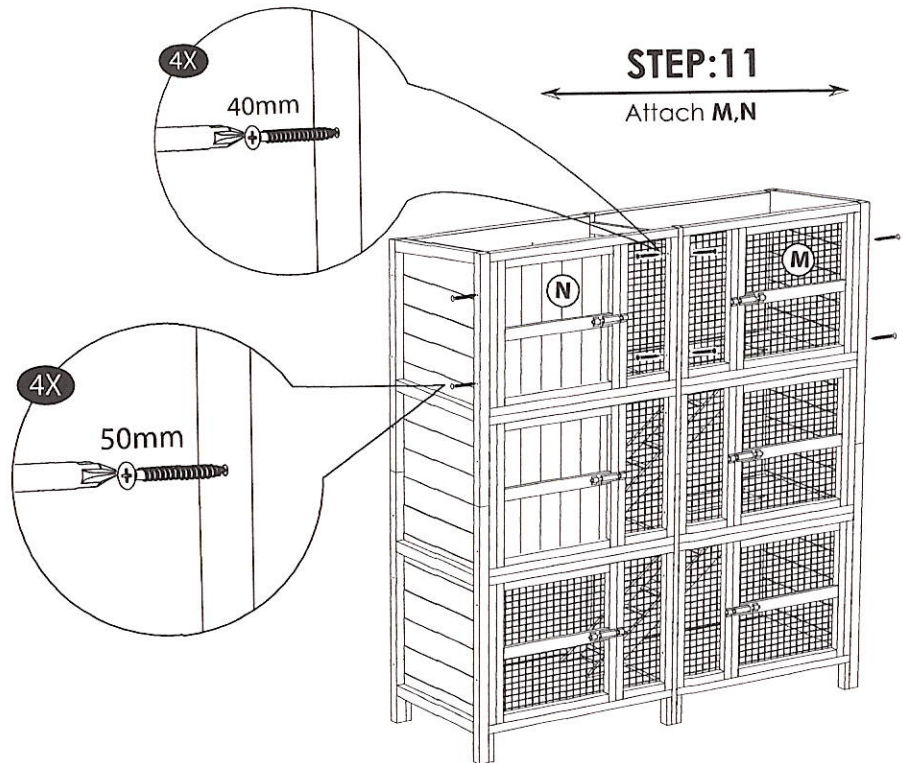

STEP:13

Attach **S** From front and Back side

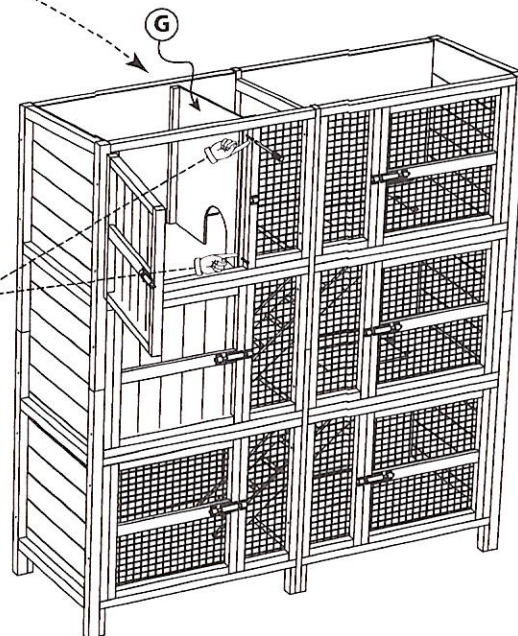
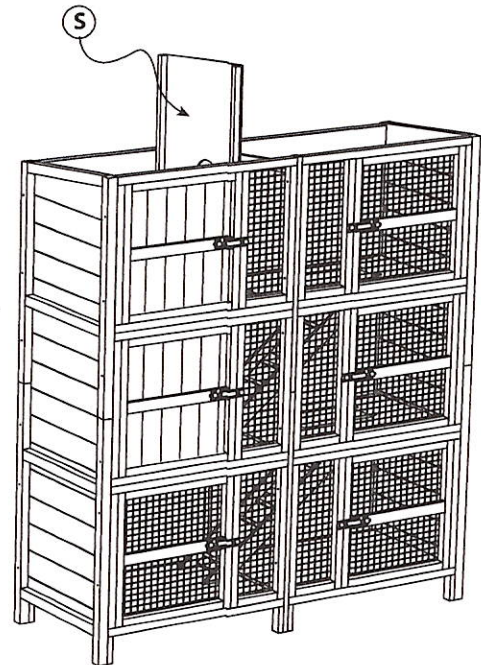
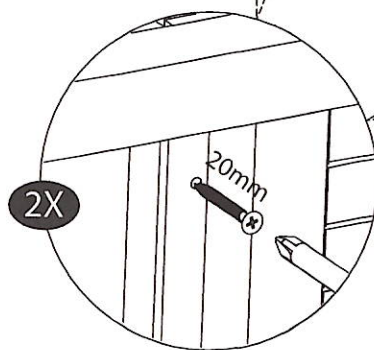
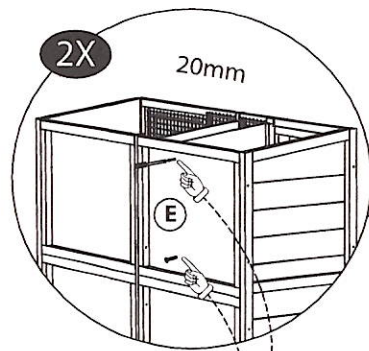

**ASSEMBLY
INSTRUCTIONS**

